

FORMATRAC[®] BENDABLE TRACK

Some Situations Demand Flexibility

○ The Formatrac® Advantage

Eliminate the hassle associated with traditional track installation and design with Formatrac® Bendable Track. Formatrac easily bends by hand on-site for simple installation. Additionally, because of its flexible nature, Formatrac can accommodate virtually any design.

Sustainable Attributes



99% Recycled
Aluminum



Cut On-Site for
Reduced Waste

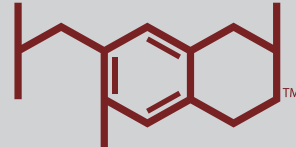

Health Product
DECLARATION

Documents Available

It's Easy to Ship and Install

- Standard track lengths allow for virtually any design or radius bend required and eliminates the need for splices.
- Easily cut on-site by hand.
- Simple installation by snapping track into grid clips.
- Versatility with virtually any ceiling type, including hard ceiling as well as regular and flush ceiling tile.
- All standard track lengths ship via UPS ground, not bulk freight.
- End caps don't have to be removed to add or remove carriers.
- Three standard track lengths available:
AL-76800-008 - 8' (2.44m), AL-76800-016 - 16' (4.88 m), AL-76800-105 - 105' (32m) rolls.
- Patented track and carriers slide quietly across track and have a peak load of over 50 lbs. (22 kg.).

It's Quiet

- Independent testing has shown significant decibel reduction with Formatrac® vs standard aluminum track equating to over 50% reduction of noise.



Watch the Formatrac® Video on YouTube!

○ Formatrac® Bendable Track Accessories



AL-76805 - Carrier with Hook



AL-76804 - Fixed End Cap



AL-76803- End Cap



AL-76806 - Spring Clip



AL-76807 - Spring Clip with Grid Clip



- BENDS EASILY BY HAND
- SIMPLE TO CARRY
- QUIET

Formatrac®

Bendable Track AL-76800

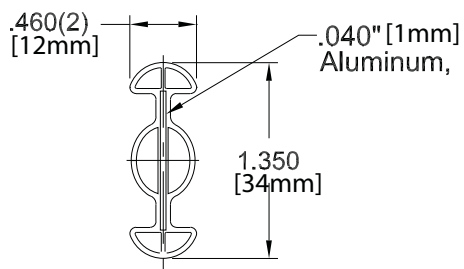
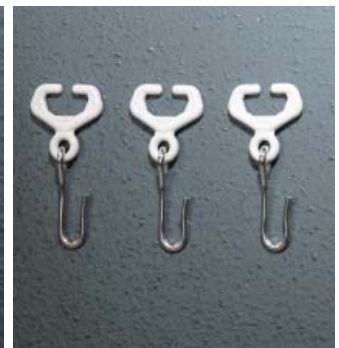

- Formatrac® bendable track is manufactured with a 99% recycled aluminum core and ABS (non-PVC) shell. This patented product results in the most durable and lightweight bendable track.
- Formatrac® bendable track is available in three standard lengths; 8'[2.4m], 16'[4.9m] and 105'[32.0m] rolls. This allows for virtually any length or radius bend required.
- Formatrac® bendable track is both easy to install and works with virtually any ceiling type including both regular and flush ceiling tile.
- Formatrac® bendable track carriers are load tested to hold 50 lbs. [22.7k] per carrier.
- Formatrac® bendable track is Class A Fire Rated.

Formatrac® Bendable Track

Suggested Specifications

PART 1 - GENERAL

1.01 SUMMARY

A. Formatrac® Bendable Track Cubicle Tracking Systems

1.02 SECTION INCLUDES

A. Formatrac® Bendable Track

B. Track accessories

1.03 SYSTEM DESCRIPTION

A. Performance Requirements: Provide Formatrac® Bendable Track system that conform to the following requirements of regulatory agencies and the quality control of Clickeze® Privacy Systems

1. Fire Performance Characteristics: Provide Formatrac® Bendable Track conforming with the NFPA Class A fire rating. Surface burning characteristics as determined by ASTM E-84, for Formatrac® Bendable Track shall be a maximum flame spread of 25 and a maximum smoke developed of 160

1.04 SUBMITTALS

A. Product Data: Manufacturer's printed product data for each type of cubicle tracking system specified.

B. Detail Drawings: Mounting details with the appropriate fasteners for specific project substrates.

C. Samples: Verification samples of cubicle track, 36" (.915m) long, in full size, with carriers, spring clip with grid clip and end caps.

D. Manufacturer's Installation Instruction: Printed installation instructions for each cubicle tracking system.

1.05 DELIVERY, STORAGE AND HANDLING

A. Deliver materials in unopened factory packaging to the jobsite.

B. Inspect materials at delivery to assure that specified products have been received.

C. Store in original packaging in a climate controlled location away from direct sunlight.

1.06 PROJECT CONDITIONS

A. Environmental Requirements: Products must be installed in an interior climate controlled environment.

1.07 WARRANTY

A. Standard Clickeze® Limited Lifetime Warranty against material and manufacturing defects.

PART 2 - PRODUCTS

2.01 MANUFACTURER

A. Acceptable Manufacturer:

Clickeze® Privacy Systems

B. Substitutions: Not permitted

C. Provide all cubicle tracking systems from a single source.

2.02 MANUFACTURED UNITS

A. Cubicle Tracking System

1. Inpro Formatrac® Bendable Cubicle Track with aluminum core.

Dimensions: height 1.375"x (34.93mm), width .450" (11.43mm).

a. White smooth finish

AL-76800- 8 foot length (2.44m)

AL-76801 - 16 foot length (4.88m)

AL-76802 - 105 foot length (32.02m)

2.03 TRACK COMPONENTS

A. Carrier: Provide thermoplastic carrier with aluminum hook.

AL-76805 Carrier

B. End Cap: Provide thermoplastic end caps in a color matching the track.

AL-76803 End Cap, white

C. Fixed End Cap: Provide thermoplastic end caps that allow the curtain to remain attached at that end.

AL-76804 Fixed End Cap, white

D. Spring Clip: Provide spring steel spring clip to hold track secure to the ceiling in a color matching the track.

AL-76806 Spring Clip, White

E. Swivel End Cap: Provide variable angle end cap that allows the track to attach to the wall at any angle.

F. Swivel End Cap with Fixed End Hook: Provide variable angle end cap that allows the track to attach to the wall at any angle and allows the curtain to remain attached at that end.

G. Spring Clip with Grid Clip: Provide spring steel spring clip with metal grid clip to hold track secure to ceiling grid in a color matching the track.

AL-76807 Spring Clip with grid clip, White for 15/16" [23.8mm] grid.

H. Radius Clip, 19": Provide an extruded aluminum and formed radius clip to create 90° bends with Formatrac®. Radius clip shall be white.

2.04 MATERIALS

A. ABS: Continuously extruded bendable track shall be produced from ABS (acrylonitrile butadiene styrene) with and aluminum core.

B. Aluminum: Continuously extruded bendable track shall be produced with an aluminum core. Core shall be alloy 3105-H2.

C. Molded Components: Molded components shall be manufactured from injection molded thermoplastic.

2.05 FINISH

A. Formatrac® Bendable Track shall be white with a smooth finish.

PART 3 - EXECUTION

3.01 EXAMINATION

A. Examine areas and conditions in which the cubicle tracking systems will be installed.

1. Complete all finishing operations, including painting, before beginning installation of cubicle tracking system materials.

2. Verify that surfaces and above ceiling supports are ready to receive work.

3.02 PREPARATION

A. General: Prior to installation, clean substrate to remove dust, debris and loose particles.

3.03 INSTALLATION

A. General: Locate the cubicle track as indicated on the approved detail drawing for the appropriate substrate and in compliance with the installation instructions.

B. Installation of Formatrac® Bendable Track

1. Install Formatrac® Bendable Track, secure and rigid, and true to ceiling line.

2. Secure track to ceiling system. Install to ceiling grid with Spring Clip with Grid Clip or Spring Clip and mechanical fasteners.

3. Slide carriers onto the track.

4. Install end caps.

5. Install curtains on carriers ensuring smooth operation.

3.04 CLEANING

A. At completion of the installation, remove any debris and clean surfaces in accordance with the clean up and maintenance instructions.

info@alcosales.com

800.323.4282

www.alcosales.com

